

# FORCE<sup>USA</sup>

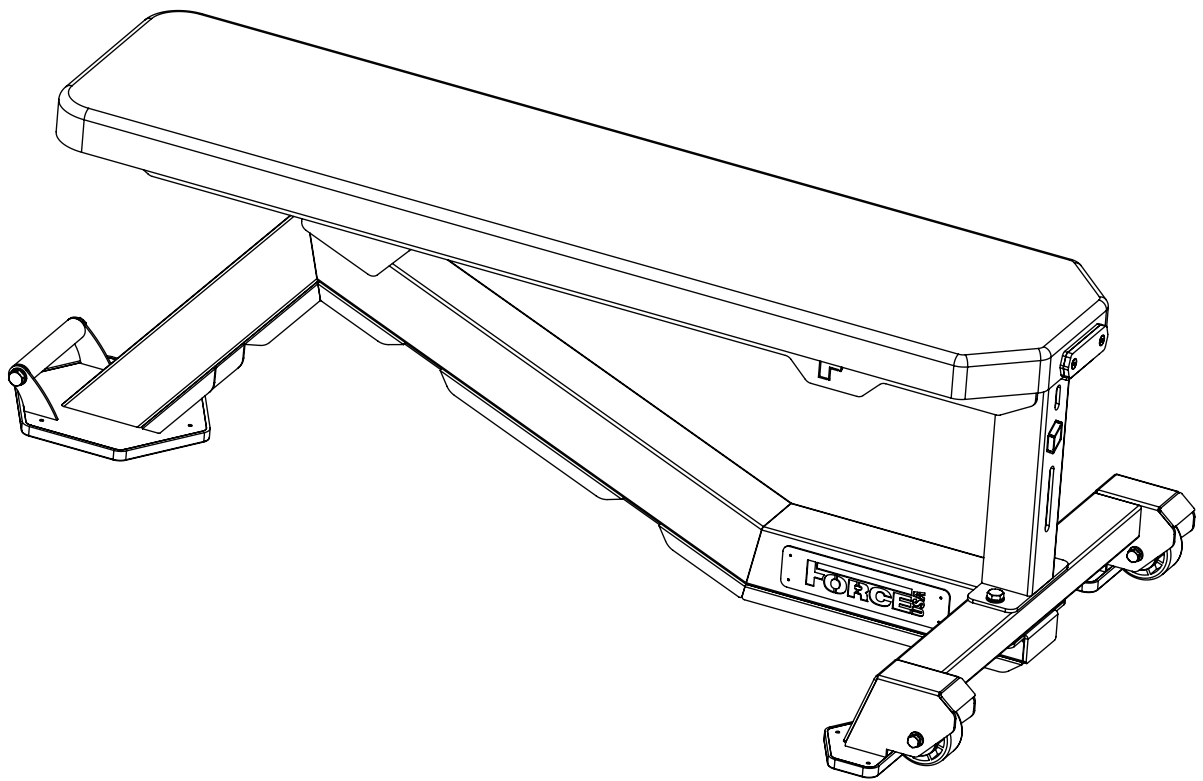

USER MANUAL | **F-PEAK-FLAT**



# **THANK YOU FOR YOUR PURCHASE**

**For the most up to date info about using  
your equipment and our latest support  
videos, please visit:**

**[www.forceusa.com](http://www.forceusa.com)**





# TRAINING APP

Download now and get access to 400+ exercise tutorials, absolutely free!



## DOWNLOAD THE APP



### STAY FOCUSED

Enjoy a low-friction interface designed to keep you focused on your next set.

### NEW WORKOUT PLANS

Loaded with a growing library of unique workouts. Hundreds of movement tutorials designed by our expert panel of coaches.

### REWARD YOUR SUCCESS

See your results build after every session with the pyramid progress tracker. Feel the support and share your progress with family and friends.

### HARDER IS GOOD

### SMARTER IS BETTER

The Force USA Training App offers customized workout plans so that you can get the same results in half the time.

Learn more at [app.forceusa.com](http://app.forceusa.com)



# BEFORE YOU START



**Read all instructions in this manual before assembling or using this equipment**



**Only tighten nuts and bolts loosely until all equipment is assembled. Once the equipment is fully assembled, tighten from the bottom up, working evenly around the unit.**

- Remove all parts from the packaging and count each component separately to ensure everything is provided correctly, noting that some items may be pre-assembled
- Follow the instructions and refer to both the individual assembly pages and the exploded views of the equipment whenever possible
- The owner is responsible for ensuring that all users of this unit have read the user manual and understand the safety precautions
- Descriptions of left and right refer to the perspective of standing in front, facing the equipment.
- Place all parts in a cleared area and remove the packing materials. Do not dispose of the packing materials until all assembly steps are completed
- It is recommended to keep these instructions

Although current at the time of this printing, specifications for this model may have changed in our continuing effort for improvement. Force USA reserves the right to modify and improve the specifications of its products without prior notice.

# BEFORE YOU START CONTINUED

---

## SAFETY PRECAUTIONS

Every piece of Force USA equipment is built for maximum safety and meets or exceeds all applicable domestic and international standards. However, certain precautions must be taken when operating any piece of fitness equipment.

- It is highly recommended that two or more people are used for assembly
- Assemble equipment on a flat surface
- Consider placing a mat/mats under the equipment to protect your floor
- Ensure all parts are in working order prior to use
- Make sure all pivoting components are able to move freely
- Do not use or store the equipment outdoors or around water
- Do not over tighten any component with pivoting function
- Keep hair, fingers and clothing away from moving parts
- Only use attachments recommended by the manufacturer
- Never operate if parts are not functioning correctly
- Always stretch prior to using equipment
- Stop immediately if you experience any pain, dizziness or nausea
- Before starting any exercise program consult your doctor

## PREVENTATIVE MAINTENANCE

To ensure your equipment is operating at its peak, please follow the below preventative maintenance schedule performing all tasks upon initial assembly:

### Daily Maintenance

- Wipe down the equipment to remove any dust and sweat residue with a dry, non-abrasive cloth
- Inspect the unit for noisy, damaged or loose components

### Monthly Maintenance

- Thoroughly clean the equipment using a non abrasive cloth dampened with a mild, all purpose cleaner ensuring to thoroughly wipe down and dry the equipment afterwards
- Apply a 100% silicone lubrication (preferably spray) to guide rods, pulley sliders, weight plate carriages and any other moving parts where friction can occur including bearings (where applicable). Any other form of lubrication will void your warranty
- Check the tightness of all bolts, nuts and screws
- Check the cables for fraying or any signs of wear and ensure they are at the correct tension with a small amount of slack at resting position (where applicable)
- Inspect pulleys for any damage or cracks (where applicable)
- Knurling can be cleaned using a soft bristled brush to help remove any particles that may be nestled within the knurling
- Vacuum around the machine/equipment to prevent dust accumulation

# PART LIST

---

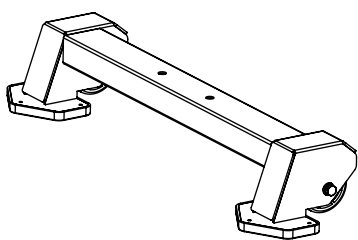

**1** x1 Rear Base Frame

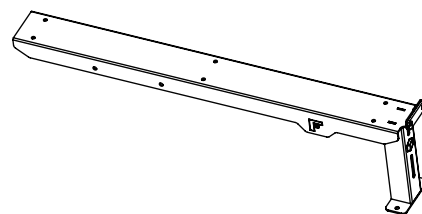

**2** x1 Back Pad Frame

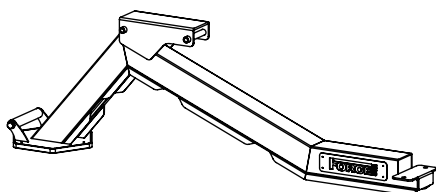

**6** x1 Main Base Frame

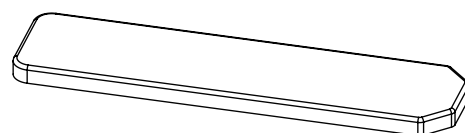

**8** x1 Back Pad

# HARDWARE IDENTIFIER

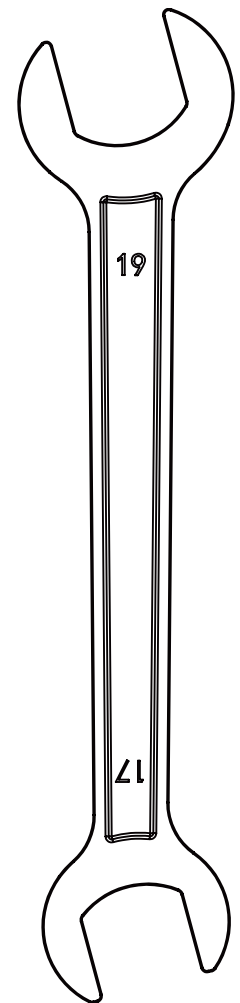
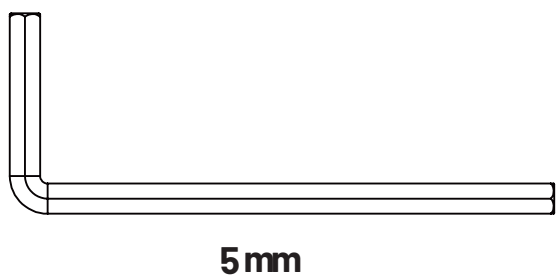
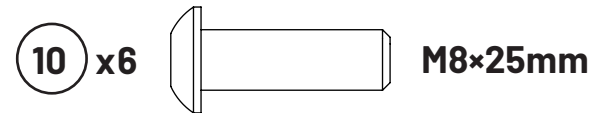
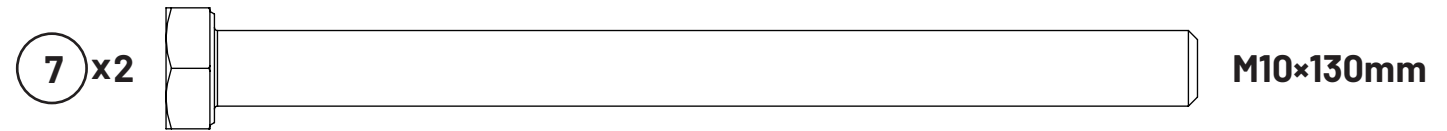
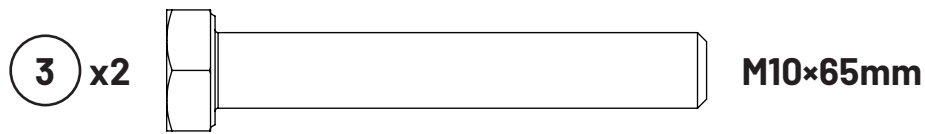

17-19  
wrench x 2



# STEP 1 - PARTS & HARDWARE

---

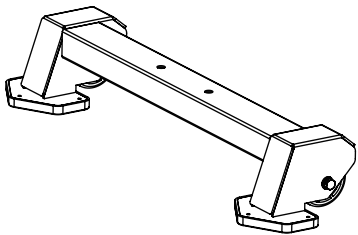

1 x1 Rear Base Frame

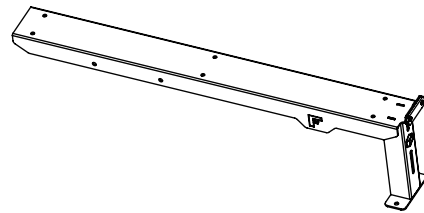

2 x1 Back Pad Frame

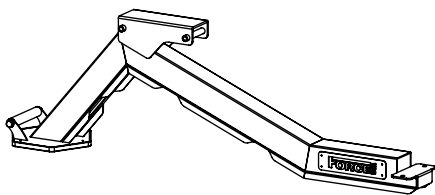

6 x1 Main Base Frame

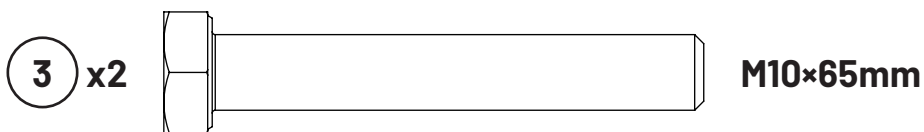

3 x2

M10×65mm

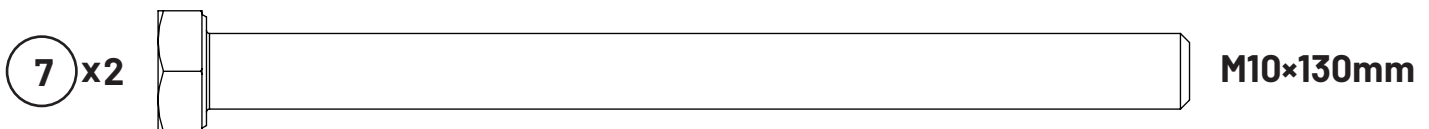

7 x2

M10×130mm



5 x4

M10 Lock Nut



4 x8

10 Flat Washer

# STEP 1 - ASSEMBLY

---

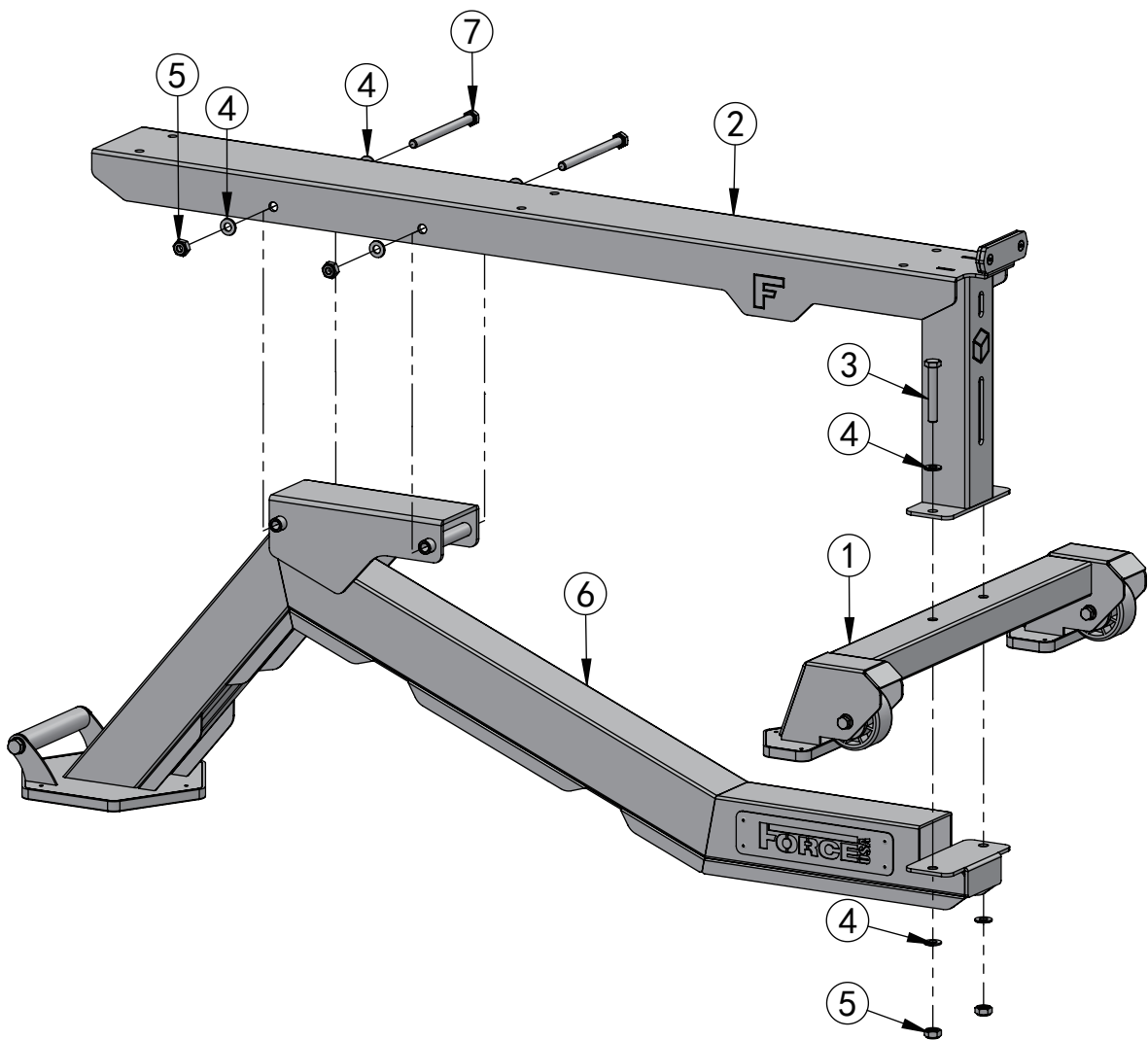

# STEP 2 -PARTS & HARDWARE

---

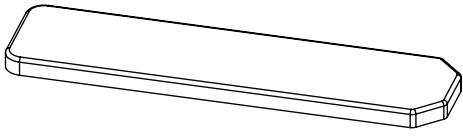

**8** x1 Back Pad

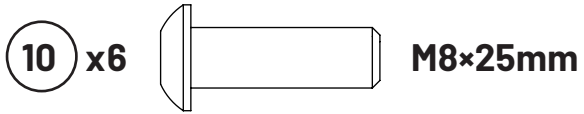

# STEP 2 -ASSEMBLY

---

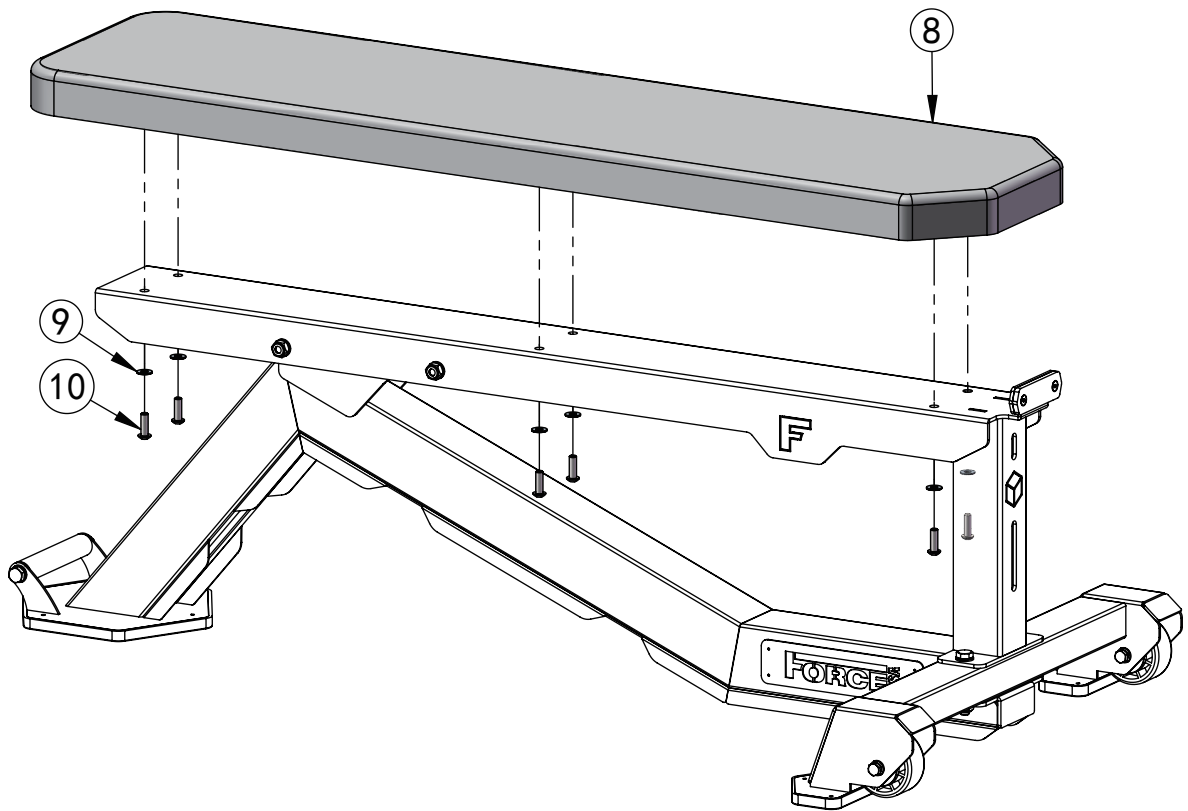

# TROUBLE SHOOTING

---

## **Weight stack top plate and guide rod assembly is floating/not resting on weight stack plate:**

The cable tension needs adjusting. There are 2 adjustment places. Either adjust the pulley that goes into weight stack by screwing it in/out of the top plate or by choosing a different bolt hole on the floating pulley. Refer to Step 7.

## **The base unit is not square or the smith machine is not resting on both sides:**

Loosen all nuts and bolts and then retighten from the bottom up.

## **What if my Smith Machine is not smooth or drags on one side:**

Ensure the unit is level and square. Clean and/or lubricate guide rods. Ensure guide rods are not bent or received any damage.

## **The cables are not smooth on one or both sides:**

Ensure cables are ONLY touching the pulley wheels. Be sure cable routing is correct so that it is not going over or under bolts or the frame.

Ensure pulley wheels are not overtightened, and each wheel is able to move freely. Add lubrication to the bearings if necessary.

# WARRANTY INFO

---

For warranty information please contact the dealer nearest to you.



<https://www.forceusa.com/locator>

# EXPLODED DIAGRAMS

## 2 x1 Back Pad Frame

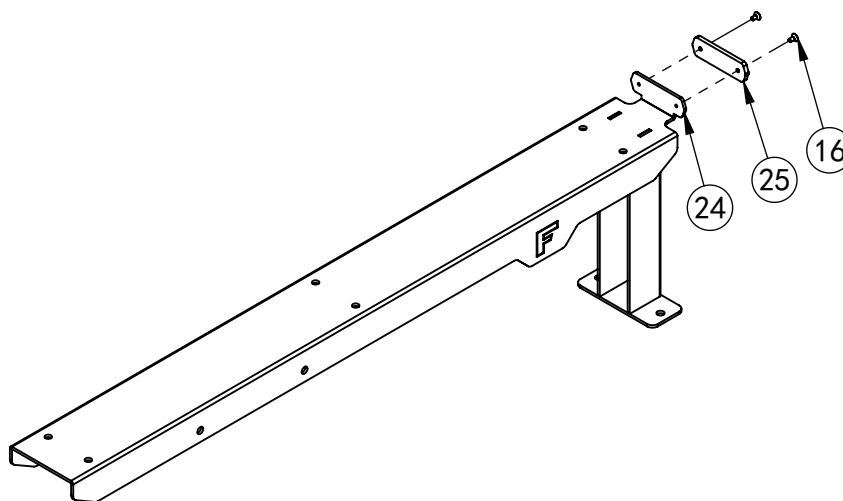

No.	Description	Note	Qty
24	Back Pad Frame		1
25	Rubber Pad	T6	1
16	Hexagon Bolt	M5×10	2

## 6 x1 Main Base Frame

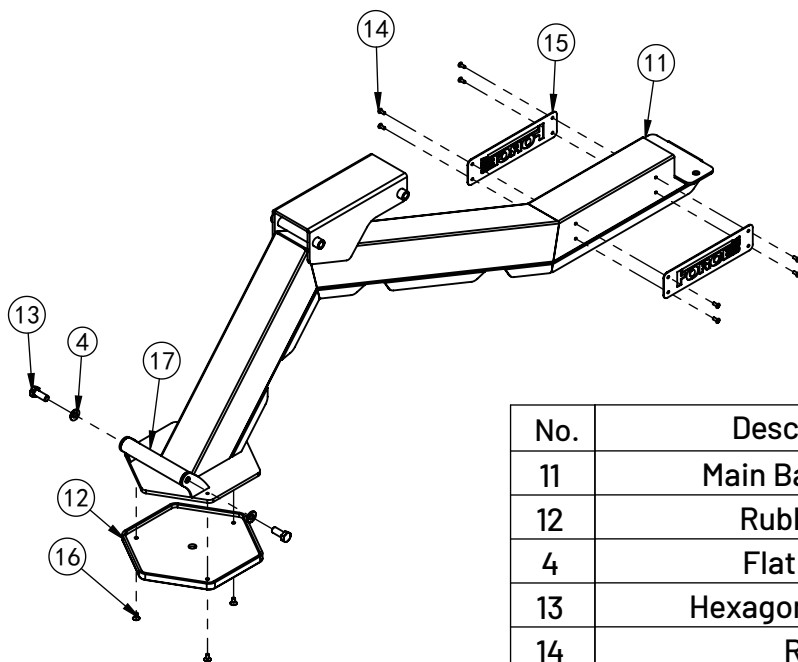

No.	Description	Note	Qty
11	Main Base Frame		1
12	Rubber Pad	200	1
4	Flat Gasket	φ 10	2
13	Hexagon Head Bolt	M10×25	2
14	Rivet	4×10	8
15	Logo Pad	T1.5	2
16	Hexagon Head Bolt	M5×10	3
17	Handle	φ 25×138	1

# EXPLODED DIAGRAMS

1 x1 Rear Base Frame

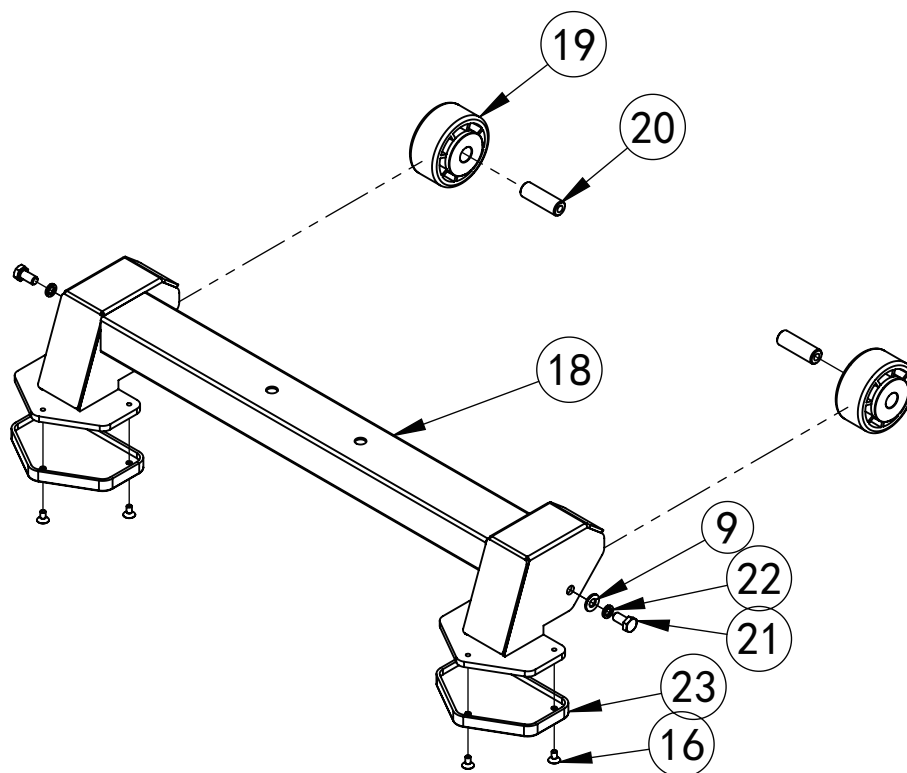

No.	Description	Note	Qty
18	Rear Base Frame		1
19	Movable Roller	$\phi$ 70	2
20	Roller Shaft	$\phi$ 14.9 $\times$ 45-M8	2
21	Hexagon Head Bolt	M8 $\times$ 16	4
22	Spring Gasket	$\phi$ 8	4
9	Flat Gasket	$\phi$ 8	4
23	Rubber Pad	126 $\times$ 45 $\times$ 10	2
16	Hexagon Head Bolt	M5 $\times$ 10	6

# PART LIST

---

No.	Description	Note	Qty
1	Rear Base Frame		1
2	Back Pad Frame		1
3	Hexagon Head Bolt	M10×65	2
4	Flat Gasket	φ 10	10
5	Lock Nut	M10	4
6	Main Base Frame		1
7	Hexagon Head Bolt	M10×130	2
8	Back Pad		1
9	Flat Gasket	φ 8	10
10	Hexagon Head Bolt	M8×25	6
11	Main Base Frame		1
12	Rubber Pad	200	1
13	Hexagon Head Bolt	M10×25	2
14	Rivet	4×10	8
15	Logo Pad	T1.5	2
16	Hexagon Head Bolt	M5×10	11
17	Handle	φ 25×138	1
18	Rear Base Frame		1
19	Movable Roller	φ 70	2
20	Roller Shaft	φ 14.9×45-M8	2
21	Hexagon Head Bolt	M8×16	4
22	Spring Gasket	φ 8	4
23	Rubber Pad	126×45×10	2
24	Back Pad Frame		1
25	Rubber Pad	T6	1

**FORCE** **USA**

[forceusa.com](http://forceusa.com)